

Spaces 04

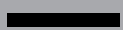

CRASSEVIG

seating solutions

side chairs
stacking chairs
swivel chairs
armchairs
lounges chairs
bar stools
counter stools
stacking stools
benches
beam seaters
dining tables
high tables
side tables

for

corporate
hospitality
educational
institutional
domestic

spaces

Made in Italy,
with passion.
www.crassevig.com

**MANY
INSPIRATIONS,
ENDLESS
POSSIBILITIES.**

**Molte ispirazioni,
infinite possibilità.**

CRASSEVIG

Spaces

/

04

From 1969 to the present day, and over three generations, creative, imaginative spirit mixed with self belief produced the high quality tradition of Italian craftsmanship that has marked Crassevig name, with tables and chairs appreciated throughout the world and distinguished by their tight, functional form. The deep experience of Crassevig provides perfect solutions for the contract market, which demands strict technical requirements together with a gratifying design for the users. For this reason, every customer's request is analyzed carefully, selecting models, materials and finishes, which better enhance the project and the environmental context. The whole Crassevig production is exclusively made in Italy, primarily with "zero-mile" principles and according to criteria of quality, safety and attention to detail, under the quality management system ISO 9001:2015. Product testing are carried out in collaboration with CATAS, the largest Italian institute and global reference point for research and testing in wood and furniture industry. Crassevig design and manufacture products respecting life and environment, following the environmental management system ISO 14001:2015. Plus, the FSC Certification guarantees that the wood used comes from responsibly managed forests. A value for the companies that produce, for those who buy and those who use the products.

IT Dal 1969, lo spirito innovativo, l'imprenditorialità, la tradizione altamente qualitativa dell'artigianato italiano contrassegnano il nome Crassevig, creando tavoli e sedute apprezzati in tutto il mondo, riconoscibili per la loro rigorosa, funzionale forma. Nel settore contract, la profonda esperienza di Crassevig garantisce soluzioni perfette che rispondono ai requisiti tecnici e mantengono una cura intensa di design ed ergonomia, di materiali e finiture.

Ogni committente può contare su una progettazione personalizzata preceduta da analisi approfondite che ne valutano sostenibilità e ottimizzazione.

Le sedie e i tavoli Crassevig sono 100% Made in Italy, concepiti per resistere a un intenso utilizzo, rimanendo sempre belli e sicuri, seguendo i severi standard del sistema per la gestione della qualità ISO9001:2015. I test sui prodotti vengono effettuati in collaborazione con Catas, punto di riferimento mondiale per ricerca e prove nel settore legno-arredo. Crassevig progetta e produce nel rispetto dell'uomo e dell'ambiente ed è certificato ISO14001:2015 e FSC®, per offrire prodotti in legno provenienti da foreste gestite in maniera corretta e sostenibile.

MANY INSPIRATIONS, ENDLESS POSSIBILITIES.

Molte ispirazioni,
infinite possibilità.

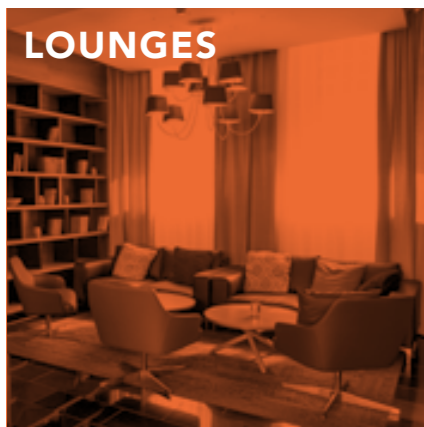

LOUNGES



EDUCATIONAL

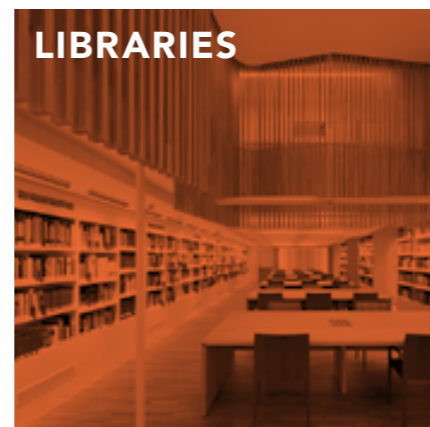

LIBRARIES



PUBLIC SPACES

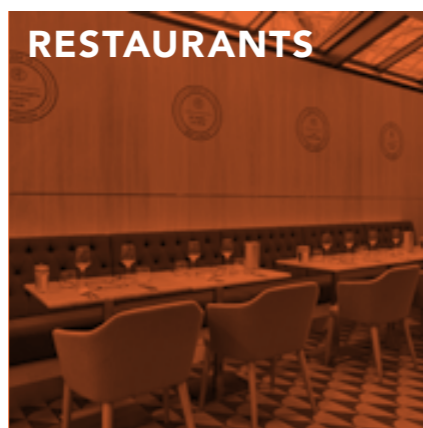

RESTAURANTS

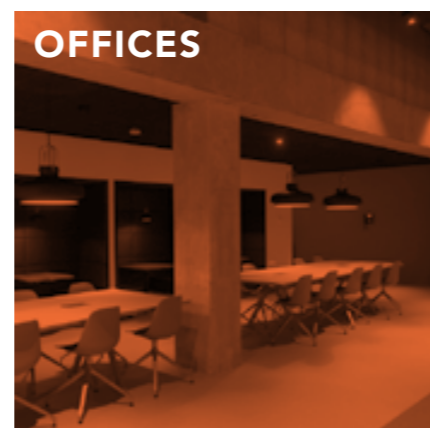

OFFICES

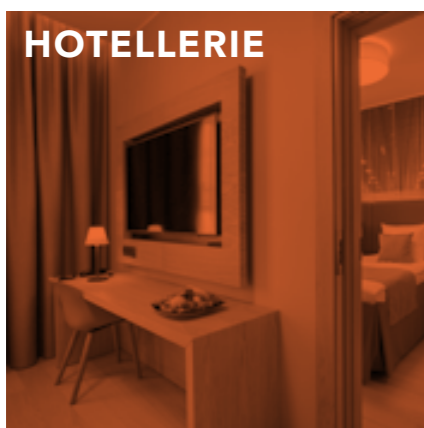

HOTELLERIE



RESIDENTIAL



CAFETERIA

OFFICES/WAITING AREAS/LOUNGES

EN Working environments that encourage an ideal balance between joint work and privacy, with welcoming and stylish waiting areas and lounge spaces that make room for socialising and relaxation, always with a personal style.

IT Ambienti operativi che favoriscono un ideale equilibrio fra la collaborazione e la privacy, zone d'attesa accoglienti ed eleganti, situazioni lounge in cui dare spazio alla convivialità e al relax, sempre con uno stile personale.

EDUCATIONAL/LIBRARIES

EN Furnishing solutions which have a positive influence on learning and concentration thanks to an ideal mix of ergonomics, comfort and practicality, integrated seamlessly within the architectural space.

IT Soluzioni d'arredo che influiscono positivamente sull'apprendimento e sulla concentrazione, grazie a una sintesi ideale di ergonomia, comfort e funzionalità, in perfetta integrazione con lo spazio architettonico.

HOTELS/RESTAURANTS/BARS

EN Spaces and atmospheres filled with warmth and elegance, with an added touch of personality and a quality that lasts, so as to meet guests' expectations and the management's specific requirements.

IT Situazioni ed atmosfere ricche di calore ed eleganza, con un tocco di personalità in più e con una qualità che dura nel tempo, per soddisfare i desideri degli ospiti e le esigenze concrete degli operatori.

RESIDENTIAL

EN Living in harmony with yourselves and the component parts of the domestic scene. Timeless sensations and contemporary inspirations cohabit in projects distinctive in their tailored crafting of details.

IT Abitare in armonia con sé stessi e con gli elementi che compongono il panorama domestico. Sensazioni senza tempo ed ispirazioni contemporanee, convivono in realizzazioni caratterizzate da una cura sartoriale del dettaglio.



Location
Paris (France)

Architecture
Bruno Gaudin

Photo
Takuji Shimmura

CRASSEVIG products
ANNA

THE ANNA CHAIR
WELCOMES READERS
IN THE LIBRARY OF
THE ÉCOLE NORMALE
SUPÉRIEURE IN LYON,
AND ALSO IN NUMEROUS
READING ROOMS IN THE
BIBLIOTHÈQUE NATIONALE
DE FRANCE.
ITS CLEAN AND ELEGANT
DESIGN MAKES IT AN
OBJECT ABLE TO BLEND
IN BOTH IN HISTORIC AND
CONTEMPORARY SETTINGS.
ADDED TO THE TIMELESS
LINES OF THIS MODEL
ARE THE LIGHTNESS,
DURABILITY AND CRAFTED
MANUFACTURE.

arch. Bruno Gaudin

IT Nella biblioteca della Scuola Normale Superiore di Lione, così come in numerose sale di lettura della Biblioteca Nazionale di Francia, la sedia Anna accoglie i lettori. Il suo design pulito ed elegante la rendono un oggetto capace di armonizzarsi sia con ambientazioni storiche che in situazioni contemporanee. Alle linee senza tempo di questo modello, si aggiungono la leggerezza, la durata e la cura nella realizzazione.



008 BIBLIOTHÈQUE NATIONALE DE FRANCE
/
PARIS

LIBRARIES



Location
Paris (France)

Architecture
Bruno Gaudin

Photo
Takuji Shimmura

CRASSEVIG products
ANNA



REFERENCES / Spaces 04



009

CRASSEVIG

010 OLYMPIC STADIUM / LONDON

RESTAURANTS

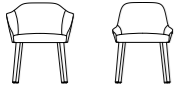

Location
London, UK

Architecture
20.20

CRASSEVIG products
AXEL

EN Built for the occasion of the 2012 London Olympics, in line with the principles of environmental sustainability, the stadium includes various spaces for hospitality, designed as exciting narrations of sporting traditions and challenges, with an idiom made up of colours, materials and style references. Comfort and durability were decisive in the choice of Axel by the interior designers.

IT Costruito in occasione delle Olimpiadi di Londra del 2012, in sintonia con i principi della sostenibilità ambientale, lo stadio comprende diversi spazi dedicati all'hospitality, concepiti come racconti entusiasmanti di sfide e tradizioni sportive, con un linguaggio fatto di colori, materiali e riferimenti stilistici. La comodità e la durata sono state determinanti per la scelta di Axel, da parte dei progettisti degli interni.



REFERENCES / Spaces 04

011

CRASSEVIG

012 OLYMPIC STADIUM / LONDON

RESTAURANTS

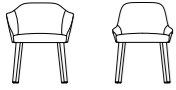

Location
London, UK

Architecture
20.20

CRASSEVIG products
AXEL



REFERENCES / Spaces 04

013

CRASSEVIG

ABUS GUTE STUBE / GUMMERSBACH

RESTAURANTS

**Location**

Gummersbach, Germany

Architecture

Raumkontor

CRASSEVIG products

POLA LIGHT



EN A global level company yet at the same time with local links, Abus is one of the main producers in Germany of industrial cranes. The interior design of this project, comprising the restaurant area, the conference and meeting areas, the auditorium and the classrooms, is a refined reference to local tradition, interweaving with the present, also through the use of an elegantly ergonomic seat such as Pola.

IT Azienda di livello internazionale, ma allo stesso tempo legata al proprio territorio, Abus è uno dei principali produttori tedeschi di gru industriali. L'interior design di questo progetto, comprendente la zona ristorazione, le aree per conferenze e riunioni, l'auditorium e le sale didattiche, allude con raffinatezza alla tradizione locale, intrecciandosi con il presente, anche attraverso l'utilizzo di una seduta elegantemente ergonomica come Pola.



016 ABUS GUTE STUBE
/
GUMMERSBACH

RESTAURANTS



Location
Gummersbach, Germany

Architecture
Raumkontor

CRASSEVIG products
POLA LIGHT



REFERENCES / Spaces 04

017

CRASSEVIG

018 LYSAKER TORG / OSLO

PUBLIC SPACES

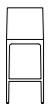

Location

Oslo, Norway

Architecture

Krohnark

Photo

Gatis Rozenfelds

CRASSEVIG products

ANNA



EN A popular meeting point with restaurants and coffee bars, devised as an open-air village, in which small houses and bar tables surround a restaurant area inspired by trattorias, with the addition of a lounge area. Anna was chosen for the timeless charm of its lines, a mix of lightness and solidity.

IT Un frequentato punto d'incontro con ristoranti e coffee bar, concepito come un villaggio a cielo aperto, nel quale piccole case e tavoli da bar attorniano una zona ristorazione ispirata alle trattorie, alla quale si aggiunge una zona lounge. Anna è stata scelta per il fascino senza tempo delle sue linee, sintesi di leggerezza e solidità.

REFERENCES / Spaces 04



020 DLR
/
BRAUNSCHWEIG

CAFETERIA

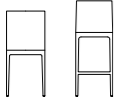

Location
Braunschweig, Germany

Architecture
HTP Hidde Timmermann Architekten

Photo
Klemens Ortmeier

CRASSEVIG products
ANNA



EN The Anna model, an original combination of technology, nature and design, was chosen for the German aerospace agency DLR, an organisation which carries out extensive research and development in the aerospace, aeronautical, energy, transport, digitalisation and security sectors, also coordinating one of the largest project management agencies in Germany.

IT Il modello Anna, originale sintesi di tecnica, natura e design, è stata scelta per gli interni dell'agenzia aerospaziale tedesca DLR, ente che svolge un'estesa attività di ricerca e sviluppo nei settori aeronautico e dell'energia, dei trasporti, della digitalizzazione e della sicurezza, coordinando inoltre una delle più grandi agenzie di project management in Germania.



REFERENCES / Spaces 04

021

CRASSEVIG

022 DLR
/
BRAUNSCHWEIG

RESTAURANTS

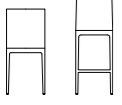

Location
Braunschweig, Germany

Architecture
HTP Hidde Timmermann Architekten

Photo
Klemens Ortmeier

CRASSEVIG products
ANNA



REFERENCES / Spaces 04

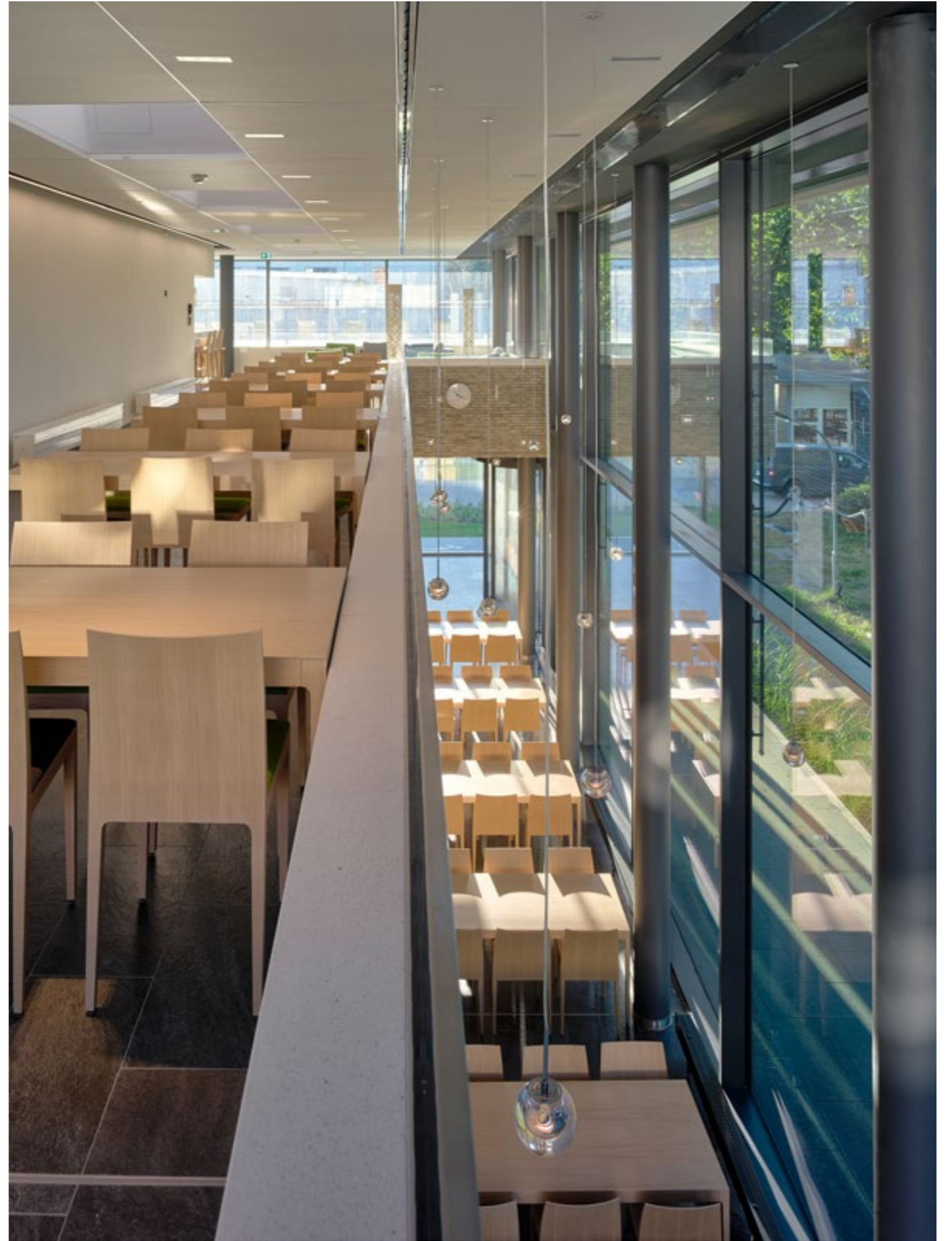

023

CRASSEVIG

GRAN CAFÉ AAN DE BEEK / ARNHEM

**Location**

Arnhem, Holland

CRASSEVIG products

NETT



EN Opened in 2016 in Arnhem, the Grand Café Aan de Beek is not only a cozy place for a refined lunch overlooking the beautiful Park Sonsbeek, but also a prestigious place for business meetings, video conferences, conventions and events. The interiors are a mixture of typical Dutch warmth with contemporary architecture and design, where Nett chairs and stools stand out for the particular design of their shells, characterized by web-like holes with a three dimensional effect.

IT Inaugurato nel 2016 ad Arnhem, il Grand Café Aan de Beek non è solo un locale accogliente per gustare un pranzo raffinato, con vista sullo splendido Park Sonsbeek, ma è concepito anche come uno spazio prestigioso per incontri di lavoro, videoconferenze, congressi ed eventi. Gli interni uniscono il tipico calore olandese con ispirazioni di architettura e design contemporanei, fra i quali spicca l'effetto reticolare disegnato dalle sedie e dagli sgabelli Nett.



026 CURE RESTAURANT / SINGAPORE

RESTAURANTS



Location
Singapore

Architecture
Camiel Weijenberg

CRASSEVIG products
LENE



EN The design of this boutique restaurant is based on a linear and clean style, the manifestation of a refined and at the same time natural approach to cooking. The space creates an atmosphere of warmth and harmony midway between the aesthetic and the functional, through the use of wood, creating a personal and unique experience, with contribution from the Lene model.

IT Il design di questo "boutique restaurant" è improntato a uno stile lineare e pulito, espressione di un approccio raffinato ed allo stesso tempo naturale alla cucina. Lo spazio crea un'atmosfera di calore e armonia fra l'estetica e la funzionalità, attraverso l'utilizzo del legno, creando un'esperienza personale e unica, alla quale contribuisce il modello Lene.



REFERENCES / Spaces 04

CRASSEVIG

027



Location
Tokyo, Japan

Photo
Glass Eye

CRASSEVIG products
POLA
NETT



EN The Meiji university is a prestigious institution founded in 1881 and part of the most important universities in Japan's capital. The student cafeteria was renovated with the installation of Pola and Nett: two elegant models at the same time particularly suitable for intensive use.

IT L'università Meiji è una prestigiosa istituzione fondata nel 1881 e fa parte delle più importanti università della capitale giapponese. La cafeteria degli studenti è stata rinnovata con l'inserimento di Pola e Nett: due modelli eleganti ed allo stesso tempo particolarmente adatti a un utilizzo intensivo.

030 MEIJI UNIVERSITY
/
TOKYO

CAFETERIA



Location
Tokyo, Japan

Photo
Glass Eye

CRASSEVIG products
POLA
NETT



REFERENCES / Spaces 04

032 UMC HOSPITAL
/
AMSTERDAM

PUBLIC SPACE



Location
Amsterdam, Holland

Architecture
Artemis Interieur

CRASSEVIG products
NETT
POLA



REFERENCES / Spaces 04

034 UMC HOSPITAL
/
AMSTERDAM

RESTAURANTS



REFERENCES / Spaces 04

036 UMC HOSPITAL
/
AMSTERDAM

PUBLIC SPACE



Location
Amsterdam, Holland

Architecture
Artemis Interieur

CRASSEVIG products
NETT
POLA



REFERENCES / Spaces 04

EN The University Medical Center is the most important centre of its kind in The Netherlands. The restaurant project is in tune with the architectural strength of the building, underlined through the use of exposed concrete combined with pure and resistant materials. A context in which Pola and Nett are perfectly at ease, adding to the space durable qualities and pleasing sensations.

IT L'University Medical Center è il più importante centro medico in Olanda. Il progetto del ristorante è in sintonia con la forza architettonica dell'edificio, sottolineata attraverso l'utilizzo del calcestruzzo a vista, in abbinamento a materiali puri e resistenti. Un contesto nel quale Pola e Nett si trovano perfettamente a proprio agio, arricchendo lo spazio di qualità durevoli e sensazioni piacevoli.



CRASSEVIG

038 UMC HOSPITAL
/
AMSTERDAM

PUBLIC SPACE



Location
Amsterdam, Holland

Architecture
Artemis Interieur

CRASSEVIG products
NETT
POLA



REFERENCES / Spaces 04

040 TAMPERE TALO / TAMPERE

RESTAURANTS



Location
Tampere, Finland

Architecture
Amerikka

CRASSEVIG products
MIXIS

EN Renovation of the Tampere Talo congress and cultural centre involved the creation of new businesses ranging from food and beverage to retail, as well as renovation of the lounge and lobby area, respecting the features of the original architecture and the new coordinated image. A project perfectly in tune with the lightness and strength of Mixis in shades of natural wood, with a strongly Nordic style.

IT Il rinnovamento del centro culturale e congressuale Tampere Talo ha previsto la creazione di nuove attività che spaziano dalla ristorazione ai negozi, oltre al rinnovamento della zona lounge e lobby, rispettando le caratteristiche dell'architettura originale e la nuova immagine coordinata. Un progetto in perfetta sintonia con la leggerezza e la resistenza di Mixis in tonalità legno naturale, dal sapore molto nordico.



REFERENCES / Spaces 04

CRASSEVIG

042 AINSLIE FOOTBALL CLUB / CANBERRA

CAFETERIA



Location
Canberra, Australia

Architecture
Abeo Architects

CRASSEVIG products
POLA LIGHT



EN Poised between the past and present, the project for renovation of this club which dates back to the Twenties uses a balanced mix of materials and textures to create a simultaneously sophisticated and welcoming atmosphere, also thanks to the installation of Pola.

IT Fra memoria e attualità, il progetto di ristrutturazione di questo club risalente agli anni venti utilizza un bilanciato mix di materiali e texture, per creare un'atmosfera al tempo stesso sofisticata e accogliente, anche grazie all'inserimento di Pola.



REFERENCES / Spaces 04



043

CRASSEVIG



Location
Delft, Holland

Architecture
Office Winhov
Gottlieb Paledan Architects

Photo
Stefan Müller

CRASSEVIG products
MIXIS



EN The façade of the Delft city archive, in red brick, is reminiscent of library shelves, with an immediate visual reference to its main function. Inside, as well as the personnel departments, there is a coffee bar and a public reading room, characterised by the warm feeling of wood, a material which in the Mixis model takes on an enveloping and dynamic form.

IT La facciata dell'archivio cittadino di Delft, realizzata in mattoni rossi, ricorda lo scaffale di una biblioteca, con un rimando visivo immediato alla sua funzione principale. All'interno, oltre agli uffici del personale, si trovano un coffee bar e una sala di lettura pubblica, caratterizzate dalle calde sensazioni del legno, materiale che nel modello Mixis prende una forma avvolgente e dinamica.



046 CITY ARCHIVE
/
DELFT

LIBRARIES



Location
Delft, Holland

Architecture
Office Winhov
Gottlieb Paledan Architects

Photo
Stefen Müller

CRASSEVIG products
MIXIS

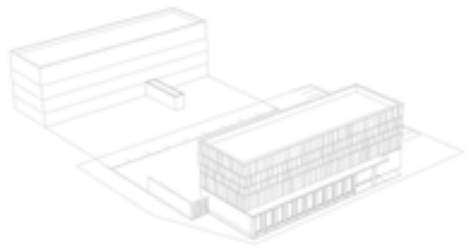

REFERENCES / Spaces 04



CENTENNIAL HOTEL / TALLINN

HOTELLERIE

**Location**

Tallin, Estonia

CRASSEVIG products

AXEL

POLA



EN A short way from the centre of the Estonian capital, the Centennial Hotel features light-filled and informal interiors, based on a minimalist style reminiscent of the best tradition in Nordic design, and finding a special affinity with the aesthetic of Pola and Axel.

IT A pochi passi dal centro storico della capitale estone, il Centennial Hotel è caratterizzato da interni luminosi e informali, improntati a uno stile minimalista che ricorda la migliore tradizione del design nordico, trovando una particolare affinità con l'estetica di Pola e Axel.



**Location**

Paris, France

Architecture

Didier Rey, Design Studio

Photo

Tristan Deschamps

CRASSEVIG products

POLA

MIXIS

NETT





EN Seven buildings for a complex of offices, restaurants and commercial spaces covering 60,000 square metres in the La Défense area of Paris. A concept of great collective architecture, respectful of the individual dimensions and with the spirit of a contemporary village. An important project in which three different models are included: Mixis, Pola, Nett.

IT Sette edifici per un complesso di uffici, ristoranti e spazi commerciali che si estende per 60.000 metri quadri nel quartiere parigino La Défense. Un concetto di grande architettura collettiva, rispettosa della dimensione individuale, con uno spirito di villaggio contemporaneo. Un progetto importante nel quale si inseriscono tre diversi modelli: Mixis, Pola, Nett.





056 TELIA EESTI
/
TALLINN

RESTAURANTS



Location
Tallin, Estonia

Architecture
Form Design

CRASSEVIG products
MIXIS



REFERENCES / Spaces 04

058 **TELIA EESTI**
/
TALLINN

RESTAURANTS



Location
Tallin, Estonia

Architecture
Form Design

CRASSEVIG products
MIXIS



REFERENCES / Spaces 04

EN The unmistakable design of Mixis is one of the key features of the head office of Telia Eesti, one of the largest telecommunications companies in the Baltic states area. In 2018 the Estonian company obtained the highest award from the Responsible Business Forum for the level of environmental and social sustainability of its business.

IT L'inconfondibile design di Mixis è fra i protagonisti della sede di Telia Eesti, una delle più grandi aziende di telecomunicazioni nell'area degli Stati Baltici. Nel 2018, la società estone ha ottenuto il più alto riconoscimento da parte del Responsible Business Forum per il livello di sostenibilità sociale ed ambientale delle sue attività.



059

CRASSEVIG

060 PRINS CLAUS CONSERVATORIUM / GRONINGEN

EDUCATIONAL



Location
Groningen, Holland

Architecture
BDG Architecten

Photo
Gerard van Beek

CRASSEVIG products
ALIS



EN The harmonious lines of Alis have become an integral part of the remodelling of this historical conservatoire, a project which has transformed the original building into a prestigious showcase for educational and cultural activities. Its design feature is a close link with musical dynamics, concerning both the architecture and the acoustics, in the classrooms and in the two concert halls and coffee bar.

IT Le linee armoniose di Alis si inseriscono nella ristrutturazione di questo storico Conservatorio, un progetto che ha trasformato l'edificio originario in una prestigiosa vetrina di attività didattiche e culturali. La caratteristica del suo design è una stretta relazione con le dinamiche musicali, sia per quanto riguarda l'architettura che l'acustica, nelle aule di concerto e nel coffee bar.



REFERENCES / Spaces 04

062 LSE SCHOOL OF ECONOMICS
/
LONDON

LIBRARIES



063

Location
London, UK

CRASSEVIG products
BIANCA



EN Founded in 1895, the London School of Economics numbers around 11,000 students from all over the world and is one of the leading European and international universities. Furnished with Bianca seating, the Women's Library was formerly a pub, converted into a library dedicated to the British and international women's liberation movement.

IT Fondata nel 1895, la London School Of Economics annovera circa 11.000 studenti provenienti da tutto il mondo ed è una delle principali università europee ed internazionali. Arredata con le sedute Bianca, la Women's Library era anticamente un pub, convertito in biblioteca dedicata al movimento di emancipazione femminile britannico ed internazionale.

REFERENCES / Spaces 04

CRASSEVIG

**Location**

Bilzen, Belgium

CRASSEVIG products

POLA

NETT



EN With its comfortable and cosy shapes, Pola is set perfectly within this high-end hotel complex, in a building dating back to the Middle Ages, with the addition of a contemporary wing comprising a top-class restaurant, spaces for meetings, events and receptions, various lounge areas as well as a wellness space, a park and an inner garden.

IT Con le sue forme comode ed avvolgenti, Pola si ambienta perfettamente in questo prestigioso complesso alberghiero, collocato in un edificio risalente al Medioevo, al quale è stata aggiunta un'ala contemporanea e comprendente un ristorante top class, spazi per meeting, eventi e ricevimenti, diverse zone lounge oltre a un'area wellness, un parco e un giardino interno.

**Location**

Bilzen, Belgium

CRASSEVIG products

POLA

NETT



068 MARTIN'S RENTMEESTERIJ
/
BILZEN

RESTAURANTS



Location
Bilzen, Belgium

CRASSEVIG products
POLA
NETT



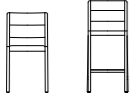

Location
Utrecht, Holland

Architecture
BuroDesk

Photo
Melanie Samat

CRASSEVIG products
ESSE

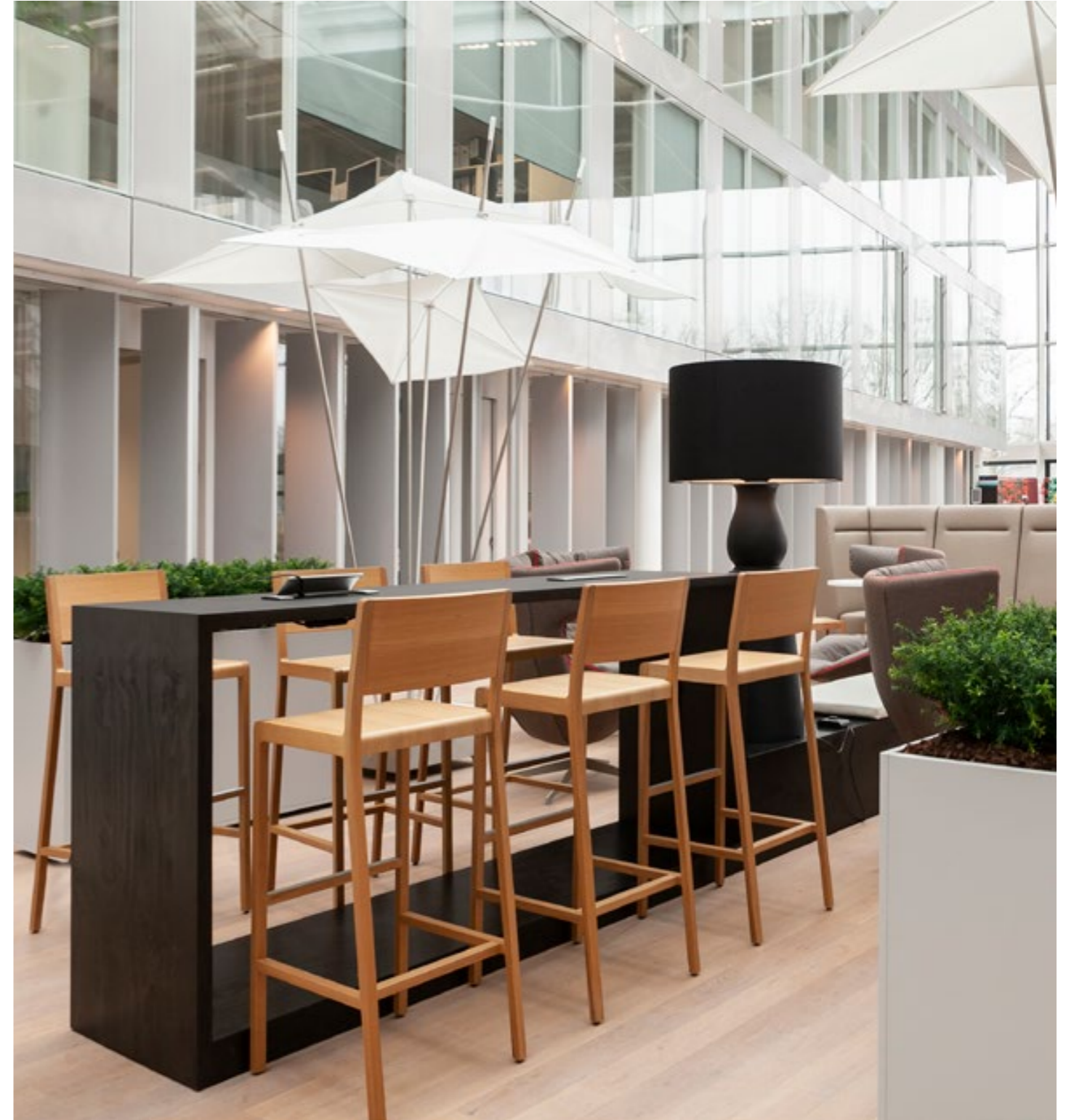

EN Rijkswaterstaat is the government agency responsible for road infrastructure and waterways in The Netherlands. In its headquarters, in a splendid and well-lit position, the restaurant area has been augmented with a multifunction hall in which staff, also coming from other locations, can work and interact in a welcoming and comfortable atmosphere thanks to Esse seating.

IT Rijkswaterstaat è l'ente governativo responsabile delle infrastrutture stradali e delle vie d'acqua olandesi. Nella sua sede principale, in una splendida e luminosa posizione, la zona ristorazione è stata arricchita con una sala multifunzionale nella quale i collaboratori, anche provenienti da altre località, possono lavorare e interagire, in un'atmosfera accogliente e confortevole grazie alle sedute Esse.

072 CAMPUS DEN HAAG / LEIDEN

EDUCATIONAL

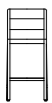

Location

Leiden, Holland

Architecture

Studio Leon Thier

Photo

Peter de Ruig

CRASSEVIG products

ESSE

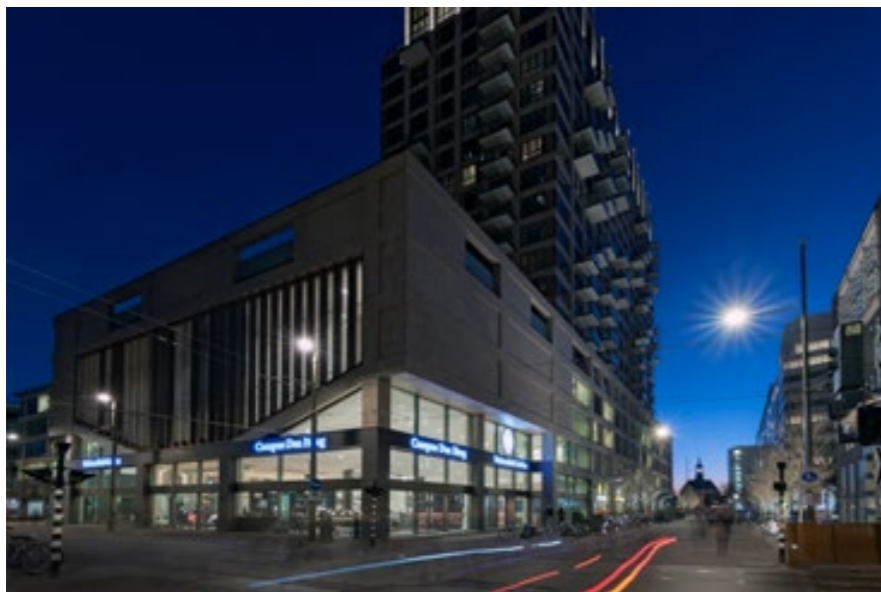

EN Leiden university is closely linked to the themes distinguishing The Hague, a city of peace, justice and security as well as a national and international governance centre. Meetings are the central motif of the interior design of the campus, in which teaching and public spaces offer a variety of settings. The Esse chair brings to this project the quality of its manufacture and the natural sensations of its raw material, wood.

IT L'Università di Leiden è legata strettamente ai temi che caratterizzano L'Aia, città della pace, giustizia, sicurezza oltre che centro nazionale e internazionale della governance. L'incontro è il motivo centrale dell'interior design del Campus, nel quale spazi educativi e collettivi offrono una varietà di situazioni. A questo progetto la sedia Esse aggiunge la qualità della sua realizzazione e le sensazioni naturali della sua materia prima, il legno.



074 SCHIPHOL KLM CATERING SERVICES / AMSTERDAM

RESTAURANTS



Location
Amsterdam, Holland

Architecture
Artemis Interieur

CRASSEVIG products
POLA
NETT



REFERENCES / Spaces 04

EN KLM Catering Services is the largest onboard catering company in The Netherlands, with 55,000 meals served daily at all hours. Intended for in-house staff, the company's new restaurant area is a large square space which records constant comings and goings of people. A particular setting in which the Pola and Nett models demonstrate their versatility and durability, as well as their aesthetic qualities.

IT KLM Catering Services è la più grande compagnia di catering a bordo nei Paesi Bassi, con 55.000 pasti serviti quotidianamente a tutte le ore. Dedicata ai collaboratori interni, la nuova zona ristorazione dell'azienda è un grande spazio quadrato che registra un continuo andirivieni di persone. Un contesto particolare nel quale i modelli Pola e Nett dimostrano la loro versatilità e durata, oltre alle loro doti estetiche.

CRASSEVIG

075



CORPORATE

AUSTRALIA

Bankwest, Sydney_Axel

Cooley Auctions, Sydney_Alis

Interactive Melbourne, Melbourne_Mixis, Bianca

Toshiba, Sydney_Pola Light

AUSTRIA

Jungbunzlauer, Wulzeshofen_Asia

Leder & Schuh, Graz_Ana

Skidata Gattenau, Salzburg_Asia

BELGIUM

Cmi Seraing, Vilvoorde_Aura

CHINA

Ericsson, Beijing_Asia

Novartis Campus, Beijing_Asia

DENMARK

Arla Food, Viby_Nett

Handelsbanken, Copenhagen_Nett

Max Bank, Naestved_Ana

ESTONIA

Telia Eesti, Tallin_Mixis

FINLAND

Air Navigation, Helsinki_Nett

Hyttest, Turku_Aura

Kaefer Oy, Rauma_Nett

Kone, Hyvinkää_Lineo

Outotec, Espoo_Nett

Supercell, Helsinki_Elba

Technopolis Linnanmaa, Oulu_Pola

Technopolis Ruoholahti 3, Helsinki_Elba

FRANCE

Agf Restaurant, Paris_Alis

Airbus Restaurant, Toulouse_Anna

Aventis Restaurant, Paris_China

Axa Insurance Corporate Restaurant, Paris_Anna

Chanel Boutique Et Bureau, Paris_Anna

Chanel Bureau, Paris_Bianca

Chassis Brakes International, Paris_Pola

Dassault System Restaurant, Paris_Anna, Asia

General Electrique_Ana

Groupama, Noisy-Le-Grand_Asia

Kenzo Parfumes, Paris_Bay

Natxis Banque Pop, Paris_Anna

Orange Telecom, Lineo

Sanofi Perisud Restaurant, Paris_Anna

Socotec, Guyancourt_Pola

GERMANY

Abus Gute Stube, Gummersbach_Pola, Nett

Expo Areal, Hannover_Asia

Rheinenergie, Koln_Ana

Rohde+Schwarz, Munich_Anna

HOLLAND

Aeres Offices, Ede_Anna

Amgen Corporate Restaurant, Breda_Anna

Bdo Accountant, S-Hertogenbosch_Anna

Bluwater Offices, Amsterdam_Mixis

Cargill, Amsterdam_Nett, Anna

Delta Lloyd Zorg, Den Haag_Anna

Deltalinqs Offices, Rotterdam_Nett

Enexis, Venlo_Nett

Frieslandcampina Innovation Centre, Wageningen_Persia

Insurance Company, Rotterdam_Asia

Kennedy Van Der Laan_Alis

Kcs Schiphol, Amsterdam_Pola, Nett

Portbase, Rotterdam_Pola

Nam (Shell), Assen_Mira

Nam Shell International Hq, Rijswijk_Anna, Mira

Rabobank Headquarters, Utrecht_Anna

Shell International, Rijswijk_Anna, Mira

Uvit Insurance, Arnhem_Esse

UWV_Asia

HONG KONG

Amazon, Pola, Mixis, Axel

INDONESIA

Gojek HQ, Jakarta_Pola

ITALIA

Biesse HQ, Pesaro_Nett

Cariparma, Credit Agricole_Bias, Mixis

Dallara Motorsport Academy, Parma_Asia, Pola, Mixis

Deutsche Bank, Milano_Maga

L'Oreal Offices, Torino_Asia, Lasa

Microtech, Milano_Pola

Pomellato Offices, Milano_Asia

Synthesis, Milano_Nett

JAPAN

Daiichi Pharmaceutical, Tokyo_Asia

Dentsu Corporation, Tokyo_Asia

Ing Life Insurance, Tokyo_Anna

K Opticom, Tokyo_Pola

Merryll Lynch Management, Tokyo_Asia

Nissan Motor Corp., Tokyo_Asia

Tobu Gas Cafeteria, Ibaraki_China

Tokyo Electron, Tokyo_Nett

Yomiuri Project, Tokyo_Asia

KOREA

LG Science Park, Seoul_Alis, Nett

Samsung, Seoul_Esse

MALAYSIA

Bhp Billiton, Kuala Lumpur_Mixis

NORWAY

Deloitte, Oslo_Nett, Pola

POLAND

Nokia Offices, Warszawa_Nett

PORTUGAL

Endemol Tv Provider, Lisbon_Anna, Goa

First Bank, Lisbon_Mira, Tancredi

SINGAPORE

Amazon, Pola, Mixis, Axel

SWEDEN

Abg Sundal Collier, Stockholm_Asia

Alfa Laval Ab, Lund_Asia

Asisto, Stockholm_Asia

Coop Kf, Stockholm_Asia

Coop Sverige, Solna_Asia

Danske Bank, Goteborg_Asia

Ericsson Offices Worldwide_Asia

Foreningsstarbenken, Nykoping_Anna

Merck, Solna_Elba

Munklägret, Stockholm_Asia

Nordea Bank, Stockholm_Mixis, Axel

Ramboll, Stockholm_Asia

Start Communication, Goteborg_Asia, Alis

Statoil, Stockholm_Bay

Sweco Marieberg, Stockholm_Nett

Swedebank, Stockholm_Nett

SWITZERLAND

Bkw Bernische Kraftwerke, Bern_Asia

Credit Suisse, Zurich_Asia

Migros, Zurich_Asia

Plus Endoprothetik, Rotkreuz_Asia

Raiffeisenbank, Ems_Asia

UAE

Linkedin Offices, Dubai_Pola Light

UK

Arla Food Uk, Leeds_Nett

Bt Newgate Restaurant, London_Alis

Etc.venues Moorgate, London_Axel

O2 Bury Call Centre, Bury_China

William Grant Whisky Offices, Scotland_Mira

USA

Ebay Offices, San Jose_Asia

State Street Bank, Boston_Nett

EDUCATIONAL

AUSTRALIA

Pymble Ladies College, Pymbi_Pola

Ryde Campus_Pola Light

AUSTRIA

Landesfeuerwehrschule, Telfs_Asia

Osterreich. Akademie, Innsbruck_Asia

TU Univeristy Of Technology Graz_Alis

Volksschule Gabelsberger, Graz_Alis

DENMARK

Naestved Handlesskole, Naestved_Asia, Alis

FINLAND

Turun Teknologiakainteistöt, Turku_Nett

Turun University, Turku_Lineo

FRANCE

Bibliotheque Universitaire Le Havre_Asia

Bibliotheque Universitaire Paris Diderot_Alis

Bibliotheque Universitaire Reims_Asia

Bibliotheque Saint Quentin_Asia

Bibliotheque Universite Nanterre, Paris_Asia

Bibliotheque Troyes_Asia

Bibliotheque Univ. Paris-Est, Marne-La-Valee_Alis

Bouygues_Ana

Centre Environmental, Gruchet Le Valasse_Anna

Ecole Normale Supérieure Ens, Lyon_Anna

Erage, Strasbourg_Alis

Isc Business School, Paris_Anna, Worktop

IPAG Business School, Nice_Pola

IUFM De L'Académie De Lyon_Asia

La Sorbonne, Bibliotheque, Paris_Anna

Mediateque Chalon Champagne_Anna

Mediateque Melun_Alis, Asia

Mediateque Mont De Marsan_Alis

Mediateque Montpellier_Anna

Novancia Business School, Paris_Alis

Sorbonne Bibliotheque Biu, Paris_Anna

GERMANY

Jovita Stiftung Die Gelbe Villa, Berlin_Anna

Wannseeforum, Berlin_Anna

HOLLAND

Academisch Medisch Centrum, Amsterdam_Pola Light

Prins Claus Conservatorium, Groningen_Alis

Openbare Bibliotheek_Asia

School, Zoetermeer_Asia

Technische Universiteit, Delft_Nett

Technische Universiteit, Eindhoven_Nett

Universiteit Leiden, Leiden_Asia

University Of Amsterdam_Anna

University Of Groningen_Asia

University Of Utrecht_Asia

HONG KONG

YCIS School, Hong Kong_Kira

ITALIA

Biblioteca, Modena_Asia

Biblioteca Comunale Guerrazzi, Genova_Asia

LBA Josef Ferrari Biblioteca, Bolzano_Anna

Università di Reggio Emilia_Asia

JAPAN

Gakken University_Nett

Ishikawa Prefectural University, Ishikawa_Alis

Japan Women's University, Tokyo_Anna

Keioh University_Asia

Komazawa University, Komazawa_Pola, Nett

Hyougo Medical University, Pola

Meiji University, Tokyo_Pola, Nett

Nissin Municipal Library, Nissin_Nett

Sagami Women University, Sagami_Asia

Youki Library_Asia

SINGAPORE

National University, Pola

SWEDEN

Konstfach, Stockholm_Asia

Rytmus School, Goteborg_Bay

University West, Trollhättan_Asia

SWITZERLAND

Sporthalle Arbon, Arbon_Pola

Arxhof, Niederdorf_Asia

Cyp School, Zurich_Asia

Kulturzentrum, Ems_Asia

Oberstufenschule Sennwald, Sennwald_Anna

UAE

United Arab Emirates University, Al-Ain_Anna

UK

London School Of Economics, London_Bianca Light

USA

Boston University, Boston, Ma_Alis

Bryant University, Smithfield, Ri_Anna

Drexel University, Philadelphia, Pa_Nett

HOSPITALITY

AUSTRALIA

Opera Bar, SydneY_Axel

Rocksia Hotel, Sydney_Nett

Westfield Chatswood, Sidney_Pola Light

AUSTRIA

Astoria Hotel, Wien_Teresa

Augarten Hotel, Graz_Nett

Bleibergerhof Gesundheitshotel, Bad Bleiberg_Anna

Cafe Aiola, Graz_Anna

Döllerer, Golling_Axel

Hilton Jazzclub Birdland, Wien_Asia

Hotel Balance Resort, Stegersbach_Anna

Hotel Bmw Ammerwald, Reutte_Esse

Hotel Kroenele, Lustenau_Esse

Hotel Krone, Bregenzwald_Esse

Jugend sportwohnheim, Kapfenberg_Pola

Konditorei Oberlaa, Friedberg_Anna

Loh Kong Yaw Keg Restaurant, Wien_Anna

Maitz, Ratsch_Esse

Pizzeria Via Veneto, St. Anton_Anna

Restaurant Sagenhaft, Groedig_Anna

Revita, Graz_Nett

Spanglerbank, Salzburg_Asia

Sporthotel, Bezau_Anna

Taperia Restaurant, Wien_Nett

BELGIUM

Festiv Bar, Antwerp_Axel

Martin'S Rentmeesterij, Bilzen_Pola, Nett

DENMARK

Da Vinci Restaurant, Hadsund_Anna, Mira

Kartellet Restaurant, Frederiksberg_Nett

Radisson Sas, Kolding_Anna

DOMINICAN REPUBLIC

Holiday Inn Puinta Cana, Santo Domingo_Stem

ESTONIA

Centennial Hotel, Tallinn_Pola

FINLAND

Casino Ray, Helsinki_Mira

Hotel Presidentii, Helsinki_Anna

MS Finlandia Ship_Nett

Palma Catering, Helsinki_Nett

Park Alandia Hotell, Aaland_Pola

Prisma Cafe, Imatra_Esse

Tampere Talo, Tampere_Mxis

FRANCE

Abbaye Du Valasse, Gruchet Le Valasse_Anna

Axa Insurances, Paris_Mira

Bistro De L'Arc, Paris_Aura

Bleu Seine Restaurant, Peniche_Anna

Chateau de Chambord Restaurant, Chambord_Anna

Edf Restaurant_Asia

Hotel Beau Rivage, Nice_Anna

Hôtel Mercure Centre Gare, Nantes_Aura

Keisuke Matsushima Restaurant, Nice_Anna

La Rascasse Restaurant, Montecarlo_Mira

Le Colysee Restaurant, Lille_Anna

Le Quinzieme, Paris_Axel

Mv4 Restaurant, Saran Cedex_Anna

Okko Hotel, Nantes_Stem

Park Expo P. De Versailles Restaurant, Paris_Anna

Pernod Ricard Restaurant_Anna

Relais Chateau St. James Restaurant, Bouliac_Lasa

GERMANY

Café Ernst, Frankfurt_Mixis

Dorint Hotel, Mannheim_Axel

Gelati e un Caffè, Dresden_China

Graupner Restaurant, Munich_Anna

Kasino Stuttgart, Stuttgart_Axel

Hotel Concorde, Berlin_Anna

Mein Schiff Tui Cruises_Axel

Radisson Blue Sas, Berlin_Anna

Restaurant Dorade, Frankfurt_Anna

Softel Ku'Damm, Berlin_Anna

Tannenhof Schonbirken, Berlin_China

The Ritz Carlton Hotel, Wolfsburg_Asia

Tui Cruises Ship_Axel

7 Days Premium Hotel, Leipzig Airport_Pola, Lineo

7 Days Premium Hotel, München_Pola, Lineo

HOLLAND

Corendon Hotel, Badhoevedorp_Nett

De Kas Restaurant, Amsterdam_Asia

Gartner Restaurant_Asia

Golf Club, Houten_Anna

Grand Cafe' Aan De Beek, Arnhem_Nett

Kasteel Radbound, Medemblik_Asia

Manna, Nijmegen_Nett

Orpheus Theater, Apeldoorn_Anna, Mira

Rhein Boats_Anna

Sheraton Amsterdam Airport, Amsterdam_Asia

HONG KONG

Public By Swire Restaurant, Hong Kong_Mixis

Silvercord Restaurant, Hong Kong_Asia

Tsing Yi City Restaurant, Hong Kong_Asia

Windsor House Restaurant, Hong Kong_Asia

INDONESIA

Marriott, Yogyakarta_Lene

ISRAEL

Asad Restaurant, Tel Aviv_Anna

ITALIA

Armandola Restaurant, Milano_Già

Backerei, Milano_Asia

Bar Lux, Vittorio Veneto_Anna

Barcaneta Restaurant, Marano_Già

Caffè Restaurant B. Gallo, Firenze_Anna

Corte Farina, Verona_Asia

G Hotel, Ancona_Bay, Gina, Ole

Get Fit Gym Cafeteria, Milano_Nett

Hotel Aurora, Sorrento_Anna

Hotel Europa, Lignano Sabbiadoro_Anna

Hotel Ibis, Milano_Asia

Hotel Ibis, Sesto Fiorentino_Arca

Hotel Memphis, Roma_Esse

Hotel Miramonti, Merano_Elba

Ice Cream Bar, Verona_Nett

Kallmunz, Merano_Anna

Ladstatterhof, Merano_Asia

Ristorante Peck, Milano_Mira, Lasa

Ristorante Time, Milano_Asia

Rota Residence, Sorrento_Alis, Worktop

Seiser Alm Urthaler, Bolzano_Bianca Light

Shi's Sushi, Udine_Nett

Tenuta Caparzo, Montalcino_Asia

JAPAN

Andaz Toranomon Hills, Tokyo_Esse

Hotel Sofitel, Tokyo_Mira

Kawasaki Nikkou Hotel, Kawasaki_Asia, Madras

Nagoya Station Hotel, Nagoya_Lasa

KOREA

Hanilwan Station, Seoul_Pola Light

W Hotel, Incheon_Aura, Otto

KUWAIT

Debenhams @ Avenues, Kuwait_Axel

The Avenues Mall, Kuwait City_Nett

LATVIA

Rumenes Muizas Manor, Riga_Latvia

New Zealand

The French Cafe, Auckland_Anna

NORWAY

Bølgen & Moi Restaurant, Tjuvholmen_Nett

Food Story Restaurant, Stavanger_Anna

PANAMA

Corvina Restaurant, Marriott, Panama_Bianca Light

PORTUGAL

Barclays Bank, Lisbon_Lasa, Gala

Hotel Marina, Albufeira_Mira

QATAR

W-Hotel, Doha_Asia

RUSSIA

Pirs Restaurant, Kazan_Aura

SLOVENIA

Hotel Mons, Ljubljana_Anna

Hotel Vandot, Kranjska Gora_Pola

Slovene National Theatre, Maribor_Anna

SOUTH KOREA

Mad For Garlic, Seoul_Pola Light

SPAIN

Espacio Torrelodones, Madrid_Nett

Sol Melia Hotel, Madrid_Asia

SWEDEN

Berns Hotel, Stockholm_Mira

Clarion Hotel Amaranten, Stockholm_Pola

First Hotel, Norrkopping_Spring

Ginos Coffee, Stockholm_Anna

Goccia Restaurant, Stockholm_Alis

Munchenbryggeriet, Stockholm_Rubber

Nk, Stockholm_Asia, Teresa

Pontus Friithof, Stockholm_Nett

Scandic Hotels_Anna

Sollentuna Shopping Mall, Sollentuna_Nett

Thon Hotel, Goteborg_Nett

SWITZERLAND

Heini Konditorei, Luzern_Bianca Light

Henris Bea Expo, Bern_Anna

Holiday Inn Express, Luzern Neuenkirch_Axel, Bay

Hotel Fravi, Andeer_Anna

Hotel Kientalerhof, Kiental_Lene

Kastanie Restaurant, Zurich_Anna

Muottas Muragl Hotel, St. Moritz_Nett

Pic Nic Restaurant, Zurich_Anna

Restaurant Il Quirinale, Geneve_Anna, Lasa

Restaurant Osoba, Zurich_Anna

Stadtbauten, Bern_Anna

Swiss Re Altbau, Zurich_Mixis

Walldhotel, Davos_Asia

Zoo Masoala Halle, Zurich_Asia

Zurich Development, Zurich_Axel

THAILAND

The Metropolitan Hotel, Bangkok_Anna

TUNISIA

Restaurant Le Golfe, Tunis_Axel

UAE

Desert Palm Hotel, Dubai_Anna

Four Season Jumeirah, Dubai_Nett

Nikki Beach Hotel, Dubai_Persia

UK

Aster Restaurant, London_Lene

10 Beauchamp, London_India, Lasa

Aldwark Hotel, York_Mira

Apex City Hotel, Edinburgh_China, Tancredi

Boardwalk Restaurant, London_Teresa

City Inns, London_Lasa

Cotswold Hotel, Chipping Campden_Lasa

Meridien Hotel_Mira

Olympic Stadium, London_Axel

Restaurant Hust, London_Mira

Restaurant Saltwater, London_Anna

Sheraton Skyline, Hayes_Mira

West Ham Olympic Stadium, London_Axel

Wigmore Hall, London_Anna

USA

Patina Group Restauration, Los Angeles_Nett

Pinkberry Yogurt Bar, Worldwide_Nett

Plantation Bay Hotels, Irvine, Ca_Nett

Roundhouse Restaurant, Beacon, Ny_Asia

Spago Restaurant, San Francisco_Teresa

INSTITUTIONAL & PUBLIC PLACES

AUSTRALIA

Airport Kingsford Smith, Sydney_Goa

Airport Tullamarine, Melbourne_Alis

Department of Industry NSW, Sydney_Pola

Wollongong Private Hospital, Sydney_Pola Light

AUSTRIA

Airport Innsbruck, Innsbruck_Anna

Akh Hospital, Linz_Anna

Altenheim, Gmund_Anna

Gemeinde St. Johann, St. Johann_Asia

Gemeinde Weiler, Weiler_Asia

Kulturverein, Graz_Anna

Landeshauptstadt, St. Polten_Asia

Landeskrankenhaus, Klagenfurt_Asia

Rehabzentrum, Penzig_Asia, Alis

Sanatorium Wehrle, Salzburg_Teresa

BELGIUM

Centrum De Kollebloem, Puurs_Pola

Landesvertretung Des Freistaates Bayern, Bruxelles_Anna

Provincie Overijssel, Kortrijk_Alis

St. Martinus Church, Genik_Nett, Pola

DENMARK

Dansk Sygeplejerad, Copenhagen_Asia

Restaurant Prego @ Cph Airport, Copenhagen_Anna

Vejle Kommune, Vejle_Nett

ESTONIA

Estonian Parliament, Tallin_Anna

Estonian History Museum, Tallin_Anna, Stem

Museum, Pärnu_Anna

FINLAND

Aralis Library, Helsinki_Asia

Esbo Stads Idrottsvsk, Helsinki_Nett

YIT Headquartes, Helsinki_Nett

FRANCE

Aéroport De Limoges, Limoges_Anna

Archives Departementales, Nantes_Anna

BNF Bibliothèque nationale de France, Paris_Anna

Conseil Generale De Loire, Nantes_Anna

Couvent De La Tourette (Le Corbusier), Eveux_Asia

Médiathèque Grand M, Toulouse_Alis

Museum Art Contemporain Mac/Val, Ivry_Anna, Asia

Museum Histoire Naturelle Cafeteria, Toulouse_Esse

Museum Petit Palais, Paris_Anna

Roissy 2-Charles De Gaulle Airport, Paris_Alis, Asia

TGI Tribunal De Grande Instance, Lorient_Anna

GERMANY

Aok Insurances, Stuttgart_Nett

Atrio, Leonberg_Persia

Bayerische Landesvertretung, Berlin_Anna

Deutsche Olympische Sportbund (Dosb) Frankfurt_Pola

Diocese Limburg, Limburg_Anna

Dlr Deutsches Zentrum Für Luft, Braunschweig_Anna

Dutch Embassy, Berlin_Asia, Massimo

Eremitage, Waghäusel_Bianca Light

Hamburgische Staatsoper/Opera, Hamburg_Anna

Kulturrühr, Bochum_Pola

Ismaning Hallenbad, Ismaning_Asia

Israelitische Kultusgemeinde, Munich_Anna

Tannenhof, Berlin_China

HOLLAND

Academisch Medisch Centrum, Amsterdam_Pola

Amsterdam Historical Museum, Amsterdam_Asia

Belastingdienst Tax Office, Utrecht_Nett

CPH Centrum Preventie, Vlaardingn_Axel, Nett

Dutch Ministry Lnv, Den Haag_Nett

Filmhuis En Museum De Domijnen, Sittard_Lineo

Gemeente Helmond, Helmond_Alis

Gemeente Lelystand, Lelystand_Asia

Gemeente Papendrecht, Papendrecht_Pola

Gemeente, S-Hertogenbosch_Anna

Historisch Centrum, Leeuwarden_Anna

Historisch Museum, Amsterdam_Asia

Icare Thuiszorg, Meppl_China

Koninklijke Marine Royal Netherlands Navy, Den Haag_Asia

Mainhouse Of Amsterdam, Amsterdam_Alis

Mainhouse Provincie Overijs_Alis

Mees Pierson Trust Bank Restaurant_Asia

Museum Sieboldhuis, Leiden_Anna

Prov. Overijssel Steunpunt_Alis

Rijkswaterstaat, Utrecht_Esse

Royal Netherlands Army Moulinkazerne, Soesterberg_Asia

Rvo Netherlands Enterprise Agency, Zwolle_Asia

Szw Ministry Of Social Affairs, Den Haag_Asia

Venw Ministry Of Transport, Den Haag_Asia

Voedsel En Waren Autoriteit, Den Haag_Asia

ITALIA

Airport Caselle, Torino_Asia, Alis

Casa Per Anziani, Lana_Asia

Comune Di Castelrotto, Bolzano_Anna

Diocesi Del Duomo Di Rimini, Rimini_Asia

Residenza Le Terrazze, Cunardo_Asia

Smo Museo, Udine_Alis

JAPAN

Arts Craft Hall, Kuroiso City_Mira

Chichibu Culture Center, Chichibu_Asia

Omiya Funeral Hall, Omiya_Anna

Takamatsu Symbol Tower, Takamatsu-City_Asia

KUWAIT

Kuwait Chamber Of Commerce, Kuwait City_Mixis

Kuwait National Assembly, Kuwait City_Mira

LUXEMBOURG

Centre Des Conferences, Luxembourg_Anna

Cour Des Comptes, Luxembourg_Anna

QATAR

Golf Administration Building Itcc, Doha_Pola Light HMC

Women's Hospital, Doha_Esse

Singapore

Airport Changi, Singapore_Nett

Opera House Esplanade, Singapore_Gina, Asia

SINGAPORE

Bukit Panjang Library, Pola

National Library Tampines Hub, Pola

SWEDEN

Abba Museum, Stockholm_Pola Light

Arena Hallen Sannarps, Halmstad_Nett

Leremus Kommun, Leremus_Asia

Norra Station M1, Hassleholm_Asia

Regionens Hus/Landstings Styrelsen, Styrelsen_Asia

Södertälje Stadshus, Södertälje_Spring

Uppsala Kommun, Uppsala_Asia

SWITZERLAND

Bildungszentrum Gesundheit und Soziales (BGS), Chur_Asia

Luks Hospital, Luzern_Anna

Frauenklinik, Zurich_China

Hospital, Basel_China

Hospital, Bern_China

Hospital, Bern_Asia

Hospital, Davos_Alis

Hpa Unispital, Bern_China

Inselspital Hospital, Bern_Anna

Inselspital, Bern_Elba

Letzigrund Stadium, Zurich_Anna

Sporthalle Arbon, Arbon_Pola

Sva Basel-Landschaft, Binningen_Asia

Weinbaumuseum, Chur_Kira

Wohnheim Kontiki, Subingen_Alis

UK

Wokingham Medical Centre, London_Asia

USA

Museo Del Barrio, New York, Ny_Nett

Seattle Art Museum, Seattle, Wa_Asia

graphic design

Genny Canton Studio

print

Grafiche Filacorda

with H-UV Technology

Rel. 01 / 2019

press office

Carter&Bennett

www.carterandbennett.compr@carterandbennett.com

tel. +39 0432 1746101

Crassevig srl

Via Remis, 25

33050 San Vito al Torre (UD)

Italy

tel. +39 0432 932896

fax +39 0432 932897

www.crassevig.comcrassevig@crassevig.com

